

FD 핑거 척

Finger Chuck



SPECIAL CHUCK

- Ideal for clamping thin-wall and fragile workpieces without distortion
- Floating clamping fingers adjust to workpiece shape
- Available in 2-jaw, 3-jaw, and 4-jaw models

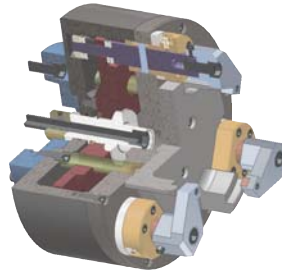

- 내경 외경 변형 우려가 있는 가공물에 적합
- 가공물의 두께편차에 대한 플로팅 기능
- 2조 3조 4조 모두 사용가능

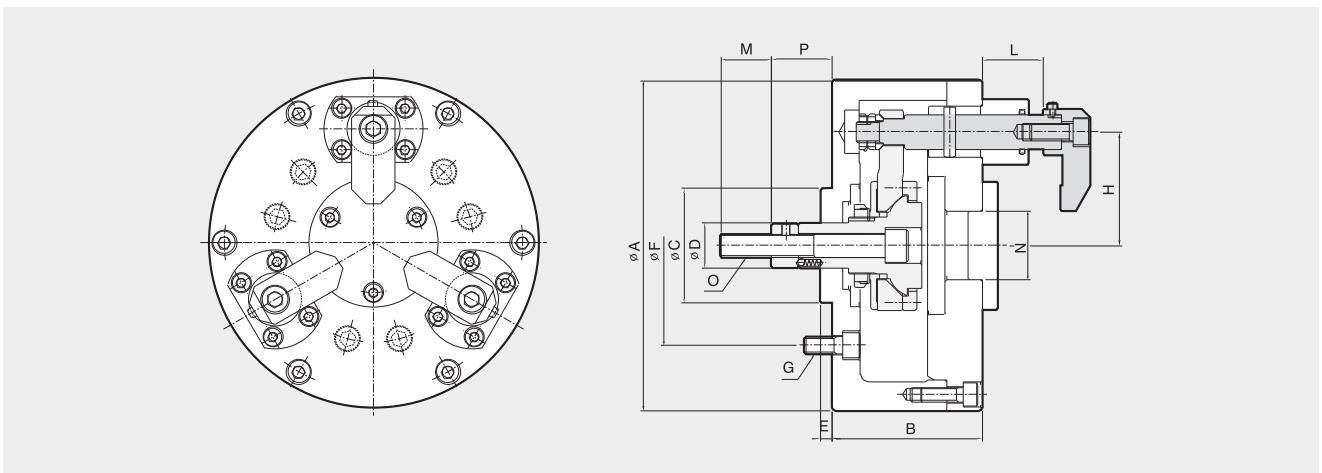

Dimensions / 치수표

	A	B	C(h')	D	E	F	G	H	Lmax.	Lmin.	M	N	O	Pmax.	Pmin.
FD-06	165	75	60	35	7	104.8	M10	55	54	30	36	40	M16	44	30
FD-08	210	85	80	42	7	133.4	M12	75	59	35	36	45	M20	50	35
FD-10	254	95	120	52	7	171.4	M16	95	72	40	46	55	M24	60	40
FD-12	304	110	120	52	7	171.4	M16	120	72	45	46	55	M24	60	40
FD-15	381	125	150	55	7	230	M20	155	84	50	50	60	M27	75	50
FD-18	457	140	150	55	7	230	M20	192	84	50	50	60	M27	75	50

Specifications / 사양

	Clamping Force (kgf)	Max. Drawbar Pull (kgf)	Jaw Compensating mm (dia)	Plunger Stroke (mm)	Chucking Diameter (mm)		Max. Speed (r.p.m.)	Weight (kg)	GD ² (kgf·m ²)
					Max	Min			
FD-06	1400	1800	2	14	75	30	3500	9	0.12
FD-08	2100	2700	2	15	110	50	2800	18	0.41
FD-10	2800	3600	2	20	145	60	2400	30	1.05
FD-12	2800	3600	2	20	195	110	2100	41	2.17
FD-15	3600	4500	2	20	260	180	1800	73	5.65
FD-18	3600	4500	2	25	330	215	1500	102	11.6