

# PBL 유니버설 볼 록 파워 척

## Universal Ball-Lock Power Chuck



**SPECIAL CHUCK**

- Castings or forgings can be O.D. or I.D. clamped
- Grips on taper up to 10°
- Jaws pivot up to 5° to grip on uneven surfaces
- Ideal for shaft machining
- Active pull-down for high precision
- 단조와 주물의 내경이나 외경 클램프 가능
- 10도 까지 경사진 각도 고정가능
- 외경 편차대응으로 5도까지 지향가능
- 샤프트 가공에 이상적

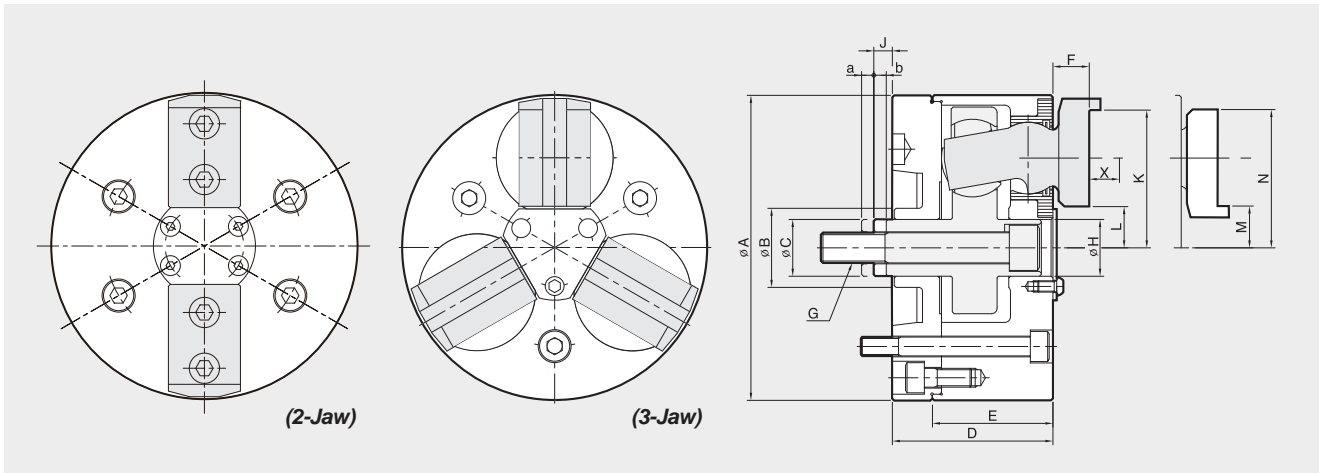
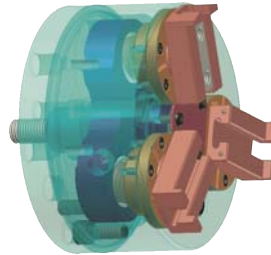

### Dimensions / 치수표

	A	B MN	C	D	E	F	G	H	J	a	b	K	L	M	N	X
PBL-06	162	40	30.16	85.2	59.2	19.3	M16	Φ30.170	10.6	5.1	6.2	73.15	20.3	22.1	75	24.9
PBL-08	200	45	31.75	100	70	23.3	M16	Φ31.760	10.4	8.0	6.4	88.95	25.3	25.35	89	29.4
PBL-10	254	58	41.27	118	86.6	29.1	M18	Φ41.285	13.5	8.0	9.5	112.7	30.2	30.3	112.8	36.5
PBL-12	300	58	41.27	118	86.6	29.1	M18	Φ41.285	13.5	8.0	9.5	133.27	50.87	50.77	133.37	36.5
PBL-15	381	83	57.16	131	96.1	32.4	M24	Φ57.160	24.7	10.3	12	171.45	65.8	69.8	175.46	41.9
PBL-18	457	120.7	88.90	131	96.1	32.4	M30	Φ88.900	31.7	10.3	12	209.55	103.9	107.9	213.6	41.9
PBL-21	533	120.7	88.90	131	96.1	32.4	M30	Φ88.900	31.7	10.3	12	247.65	142	146	252	41.9

### Specifications / 사양

	Clamping Force (kgf)	Max. Drawbar Pull (kgf)	Jaw Stroke mm(dia)	Plunger Stroke (mm)	Chucking Diameter		Max. Speed (r.p.m.)	Weight (kg)	GD <sup>2</sup> (kgf·m <sup>2</sup> )
					Outside Dia (mm)	Inside Dia (mm)			
PBL-06	7130	2375	7.9	11.3	12.7~120	70~152	4200	18	0.15
PBL-08	9780	3260	9.5	14.3	16~152	76~203	3700	27	0.48
PBL-10	12540	4180	12.7	17.5	50~203	85~235	3400	45	1.23
PBL-12	12540	4180	12.7	17.5	63~241	127~305	2800	67.5	2.42
PBL-15	16800	5600	15.8	22.3	76~317	165~381	2000	84.5	8.49
PBL-18	16800	5600	15.8	22.3	89~394	241~457	1500	120	15.17
PBL-21	16800	5600	15.8	22.3	162~470	317~533	1000	180	25.00



**Centralizing**

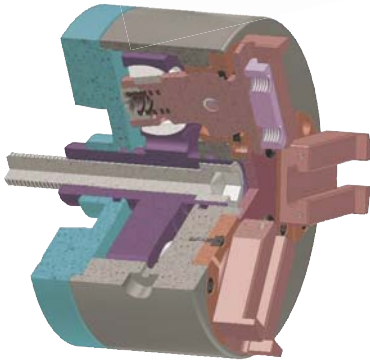

**Compensating**

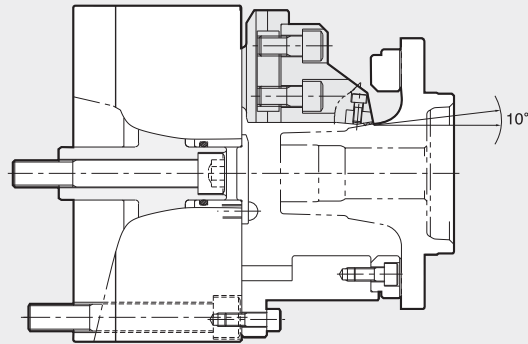
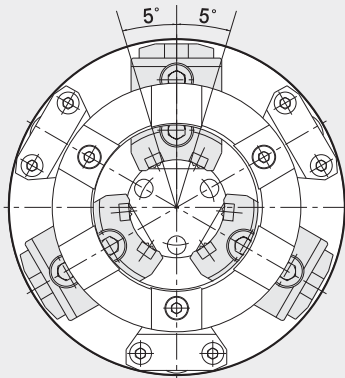
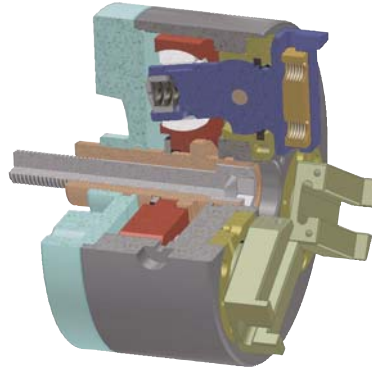

**PBL Components**

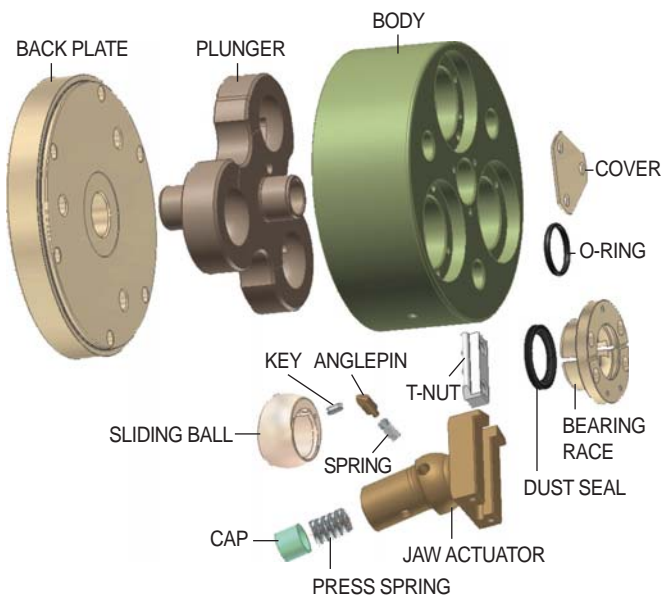

**Inserts**

Angle Lot Style		
PC127-10SC	PC127-4SC	PC130-4SC
PC132-4SC	PC145-5SC	
PC127-4SC-S	PC130-2SC-S	
Round Style		
PC070-12SC	PC070-4SC	